

PLAT OF SURVEY

LEGAL DESCRIPTION:

A PARCEL OF LAND LOCATED IN THE NORTHWEST 1/4 OF THE SOUTHWEST 1/4 OF SECTION 5 IN TOWNSHIP 1 NORTH, RANGE 17 EAST, IN THE TOWN OF LINN, WALWORTH COUNTY, WISCONSIN, MORE PARTICULARLY DESCRIBED AS:

LOT 1 AND 2 OF CERTIFIED SURVEY MAP NO. 1650 AS RECORDED IN DOCUMENT NO. 156419 AS PER THE WALWORTH COUNTY REGISTER OF DEEDS.

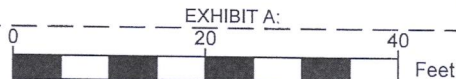
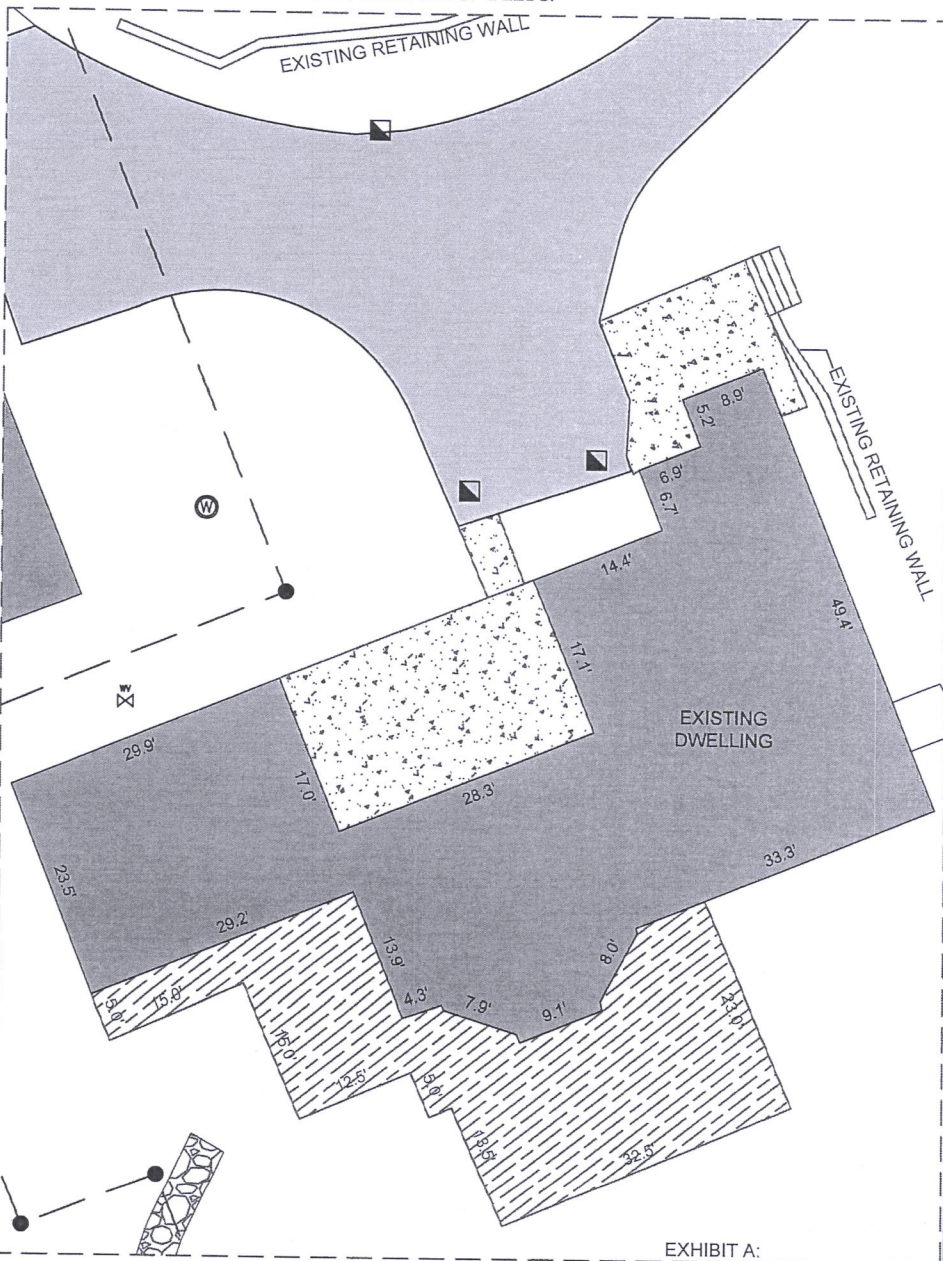

SCALE: 1"=20'

LEGEND

- FOUND 1" IRON PIPE
- FOUND IRON ROD
- ⊗ SET MAGNETIC NAIL
- ▨ EXISTING BUILDING
- ▨ EXISTING DECK
- ▨ EXISTING CONCRETE
- ▨ EXISTING STONE WALKWAY
- ⊙ EXISTING SEPTIC LID
- ⊙ EXISTING WELL
- ▣ EXISTING DRAIN
- ⊙ EXISTING COMMUNICATION BOX
- ⊙ EXISTING MANHOLE
- ⊙ EXISTING WATER VALVE
- (XX) RECORDED AS PER CSM 1650

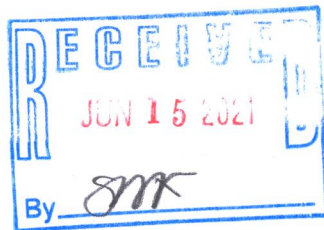

SURVEY ORDERED BY:
BALSITIS CONTRACTING, INC.
PROPERTY ADDRESS:
W4465 N LAKE SHORE DRIVE
WILLIAMS BAY, WI
SURVEYOR:

PAUL H. VAN HENKELUM, PLS
CARDINAL ENGINEERING LLC

"I HEREBY CERTIFY THAT I HAVE SURVEYED THE ABOVE DESCRIBED PROPERTY AND THE MAP IS A TRUE AND CORRECT REPRESENTATION OF ITS EXTERIOR BOUNDARIES AND SHOWS THE SIZE AND LOCATION OF ALL VISIBLE STRUCTURES, APPARENT EASEMENTS AND ENCROACHMENTS, IF ANY.

PAUL H VAN HENKELUM, PLS #1931
DATE 6/2/2021

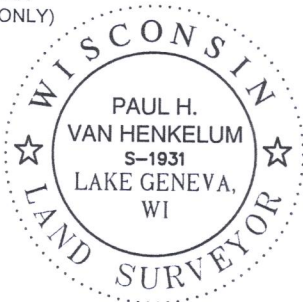

GENEVA LAKE

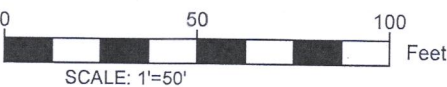

SCALE: 1"=50'

APPARENT ORDINARY
HIGH WATER MARK
(FOR REFERENCE ONLY)

NOTE:

1. BASIS OF BEARING: THE WISCONSIN STATE PLANE COORDINATE SYSTEM, NAD-83, SOUTH ZONE.
2. FIELD WORK COMPLETED APRIL 19, 2021
3. BUILDING SURVEYED TO THE EXTERIOR OF SIDING.
4. FIELD CREW CHIEF: LUKE COFFEY
5. DECK SHOWN VIA WALWORTH COUNTY GIS



CARDINAL ENGINEERING LLC
DESIGNING IN TRUE DIRECTIONS

PO BOX 281 - 1200 LA SALLE ST.
LAKE GENEVA, WI 53147
262-757-8776
CARDINALENGINEERINGWI.COM

DATE: 06/02/2021 JOB No. 21379
SHEET 1 OF 1 EJO

IA1650-1 IA1650-2

117-4520